

# JUST... *Spitzingsee*



## **FOCUS ON GETTING THE JOB DONE IN A RELAXED ATMOSPHERE**

Where the road ends, at 1,100 meters, lies the Arabella Alpenhotel am Spitzingsee. 10 meeting rooms for up to 160 people provide space for conferences, symposiums, workshops, and incentives. The mountains, the lake and the tranquil setting creating the perfect framework for concentrating on work. The hotel has 120 rooms and suites, designed in an Alpine farmhouse style. To recharge your batteries, head to the AlpenSPA with its first-rate panoramic views.



## **LOCATION**

Mountain village at 1,100 meters, on the shore of Lake Spitzingsee and just 1 hour drive from Munich

## **ROOMS**

120 rooms and suites

## **SEMINAR AND CONFERENCE FACILITIES**

- Conference center "Seehof"
- 10 meeting rooms
- Capacity: 160 persons

## **WINING & DINING**

- "König Ludwig"  
Regional, international cuisine for up to 160 guests, lakeside terrace
- "Osteria L'Oliva"  
Mediterranean cuisine for up to 90 guests, lakeside terrace
- "Spitzing Alm"  
Bavarian cuisine for up to 100 guests, lakeside terrace, beer garden
- Wine cellar for 12 guests, wine tastings
- Lobby bar

## **WELLNESS & FITNESS**

AlpenSPA: pool, whirlpool, sauna, beauty farm and fitness lounge

## DOING BUSINESS BETWEEN THE MOUNTAINS AND THE LAKE

At the "Seehof" conference center and in the hotel, you may choose between 10 room versions to find the perfect solution for your event. There is room for up to 160 people. All rooms come with daylight, free Wi-Fi and state-of-the-art conference technology.

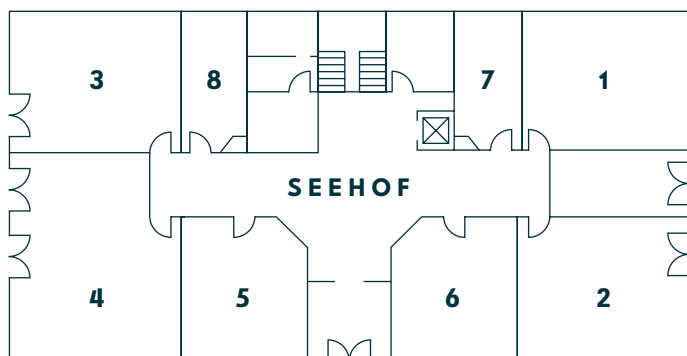

### SEEHOF

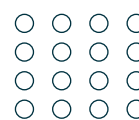
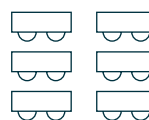
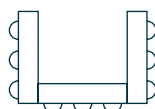

Room	Area (m <sup>2</sup> )	Tables	Chairs	Capacity	
<b>1+2</b> Neuschwanstein	162m <sup>2</sup>		50	100	160
<b>1</b> Neuschwanstein 1	96m <sup>2</sup>	28	30	50	85
<b>2</b> Neuschwanstein 2	66m <sup>2</sup>	18	23	30	45
<b>3</b> Herrenchiemsee	66m <sup>2</sup>	18	23	30	45
<b>4</b> Hohenschwangau	96m <sup>2</sup>	28	30	50	80
<b>5</b> Nymphenburg	48m <sup>2</sup>	16	15	19	30
<b>6</b> Linderhof	48m <sup>2</sup>	16	15	19	30
<b>7</b> Hohenaschau	25m <sup>2</sup>	10			
<b>8</b> Blutenburg	25m <sup>2</sup>	10			

### MAIN BUILDING

Wappensaal	58m <sup>2</sup>		20	20	55
Rotwand	44m <sup>2</sup>	24			

## ARABELLA ALPENHOTEL AM SPITZINGSEE A NATURAL GEM

We would also be happy to advise you when it comes to planning your support program. Depending on the number of attendees, the time of year and the duration of your event, we can suggest and organize suitable activities and adventure packages for you, either in summer or winter. The unique location of our hotel means that there is a wealth of activities available right outside our front door without any travel time.

**SUMMER:** hikes with rest stop at a mountain hut, raft building, mountain cart rides, quad tours, torchlit hikes around the lake, adventures in the high-rope garden, dragon boat race, team cooking, llama/alpaca hikes and much more.

**WINTER:** torchlit or snowshoe hikes, sledding, skiing, cross-country skiing with a stopover in a mountain hut, llama/alpaca hikes, igloo or snow bar building, rides in a horse-drawn sleigh, biathlon races for beginners and much more.