

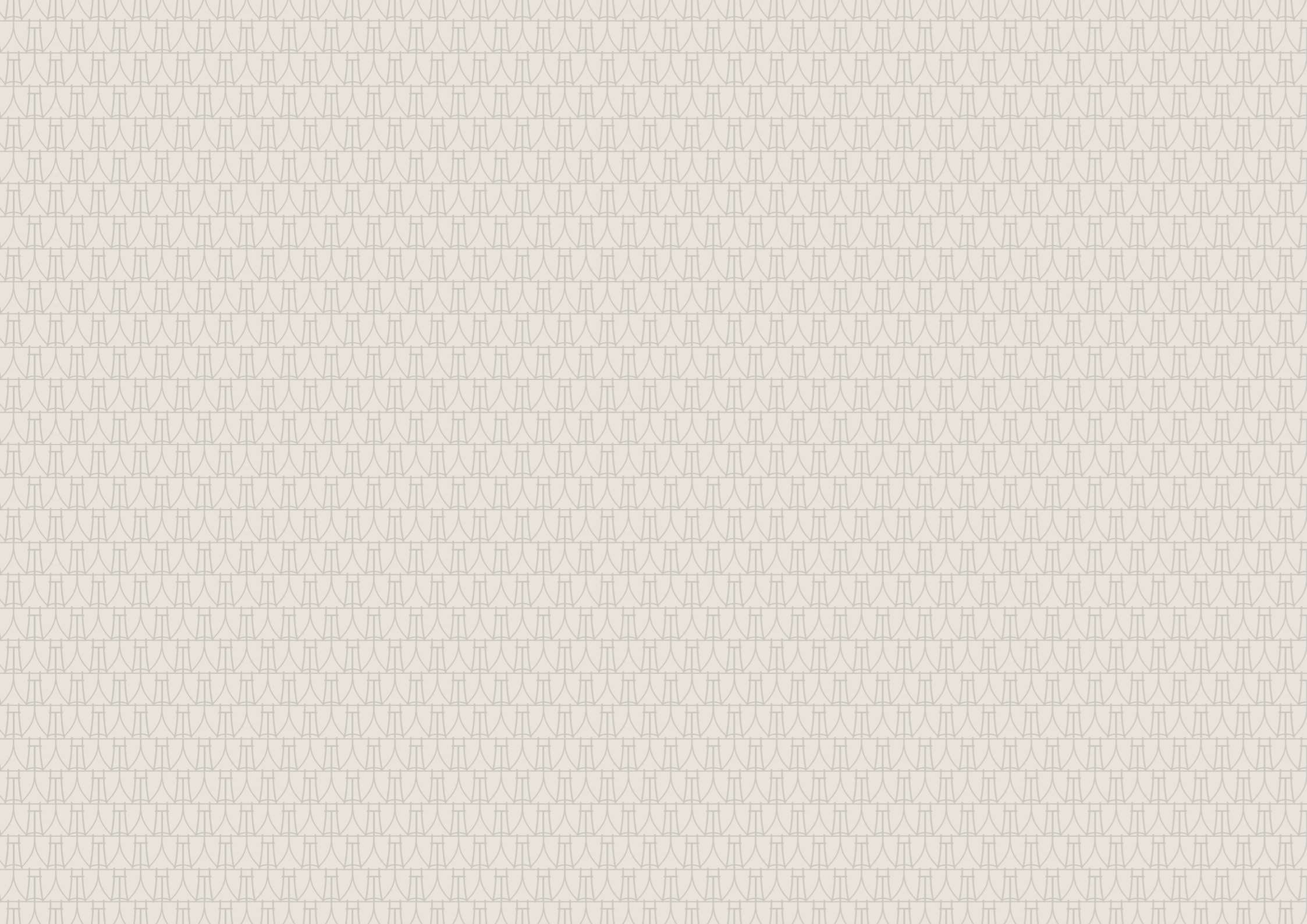

HERMITAGE

HOTEL PRAGUE



Visit Prague

Discover the heart of Europe and one of the most beautiful cities in the world, steadily ranking among the most popular destinations. Prague, the capital of the Czech Republic, the city of kings, artists and builders, from the medieval ones to the famous modernists of the 20th century. It is the city of hundred spires, gardens and countless monuments in and beyond the historic center which has been a UNESCO World Heritage Site since 1992.





Great Location to Discover Prague

Hermitage Hotel Prague is the right place to stay; a place where you have all the beauty of Prague within your reach. Simply go out and enjoy the view of the Prague skyline and, at the same time, the tranquility of an authentic Prague district right by the Vltava River, away from overwhelming tourist crowds. Famous historical monuments can be comfortably explored on foot, as well as the Prague Congress Center nearby.





Your Type of Hotel

Hermitage Hotel Prague is a four-star hotel with unique atmosphere, impeccable service and maximum comfort. Hermitage Hotel Prague has come into existence through an original alternation of an Art Nouveau printing house built in 1907 in a charming place below Vyšehrad Castle, at the right bank of the Vltava River.



HISTORY SINCE 1907

We intended to preserve the spirit of the impressive Art Nouveau building while creating a comfortable place with top-level modern service. That is why we have carefully renovated the exteriors and sensitively adapted the interiors of the building so as not to disturb the airy and elegant architecture.



Safe Hotels Premium



Traveller's Choice



Green Key

Your Type of Service



Great Location

Enjoy the proximity of the historical center as well as the tranquility of an authentic Prague neighborhood right by the Vltava River, away from the tourist crowds.



Historical Building

Discover the singular atmosphere of a former Art Nouveau printing house that, after a unique alteration, has a modern and cozy character that will impress you.



High Standard Service

Indulge in care that exceeds all your expectations. It goes without saying that personal approach and assistance in every situation are absolutely essential to us.



Restaurant & Bar

Savor the best of Czech and world cuisine at the Type restaurant as well as top shelf drinks prepared by our experienced bartenders.



Fitness & Sport

You can either use our state-of-the-art rooftop fitness center with a terrace or take advantage of the ideal location of the hotel close to popular running trails and cycling tracks .



Parking

You can park your car conveniently right in the hotel. Both guarded parking garage and monitored outside parking is available.





 The Monastery "The Monastery" was founded in the 14th century by the Czech king Charles IV for his youngest son, the Duke of Silesia, who was a Catholic duke. The monastery was built in the Gothic style and was one of the most important religious centers in the region. The building was destroyed during the Hussite Wars and was later rebuilt in the Baroque style. The monastery was closed in 1775 and was used as a prison until 1848. Today, the building is a part of the Hotel Park Inn Prague.

Emauz – The Monastery Na Slovanech



 The Monastery "The Monastery" was founded in the 14th century by the Czech king Charles IV for his youngest son, the Duke of Silesia, who was a Catholic duke. The monastery was built in the Gothic style and was one of the most important religious centers in the region. The building was destroyed during the Hussite Wars and was later rebuilt in the Baroque style. The monastery was closed in 1775 and was used as a prison until 1848. Today, the building is a part of the Hotel Park Inn Prague.







Hotel Park Inn Prague otevřen



Hotel Park Inn Prague is opened







Your Type of Accommodation

What awaits you in Hermitage Hotel Prague?
Comfortably furnished rooms, restaurant offering both Czech and international cuisines, bar for evening relaxation, fitness center, monitored garage parking and professional grounds for holding conferences... And on the top of that, you have Prague at your fingertips.





Your Type of Rooms

Free Wi-Fi, tea and coffee making facilities and minibar are, of course, provided in every room at Hermitage Hotel Prague. We are ready to meet your wishes even if you require more space, a terrace or if you prefer the comfort of your own suite. All you have to do is to choose your type of room.





Standard

SIZE: 22 m²
 MAX. GUESTS: 2 adults, 1 child
 BEDS: queen size or twin beds

- Wi-Fi
- Minibar
- In-room Safe
- Magnifying Mirror
- A/C
- Access to Fitness
- Coffee & Tea Facilities
- Room Service
- Hair Dryer
- Flat Screen TV
- Room Climate Control
- Bathroom with Walk-in Shower



Superior

SIZE: 30 m²
 MAX. GUESTS: 3 adults
 BEDS: queen and king size or twin beds

- Wi-Fi
- Minibar
- In-room Safe
- Magnifying Mirror
- A/C
- Access to Fitness
- Extra Bed
- Coffee & Tea Facilities
- Room Service
- Hair Dryer
- Flat Screen TV
- Room Climate Control
- Bathroom with Walk-in Shower



Superior with Terrace

SIZE: 25 m²
 MAX. GUESTS: 3 adults
 BEDS: king size bed

- Wi-Fi
- Minibar
- In-room Safe
- Magnifying Mirror
- A/C
- Access to Fitness
- Nespresso
- Private Terrace
- Coffee & Tea Facilities
- Room Service
- Hair Dryer
- Flat Screen TV
- Room Climate Control
- Bathroom with Walk-in Shower
- Bathrobe & Slippers
- High Floor



Suite

SIZE: 62 m²
 MAX. GUESTS: 4 adults
 BEDS: king size bed

- Wi-Fi
- Minibar
- In-room Safe
- Magnifying Mirror
- A/C
- Access to Fitness
- Nespresso
- Private Terrace
- Living Room
- Coffee & Tea Facilities
- Room Service
- Hair Dryer
- Flat Screen TV
- Room Climate Control
- Bathroom with Walk-in Shower
- Bathrobe & Slippers
- High Floor
- Free Parking





Your Type of Dining

We will make sure that every visit to our hotel restaurant and bar is an unforgettable experience. At the Type Restaurant & Bar, we serve selected dishes of the traditional Czech cuisine as well as a varied range of international dishes, including our grilled specialties. You can end the evening at the hotel bar with a glass of good wine, traditional Czech beer or a cocktail that we will mix to your liking.



type

RESTAURANT & BAR

BREAKFAST

Our varied buffet breakfast is a great start to a new day; we offer anything from healthy choices to traditional English breakfast. Breakfast can be ordered via room service or to go.



Your Type of Events

Hermitage Hotel Prague offers 6 fully equipped conference rooms for up to 160 people, and 210 stylishly furnished hotel rooms. For your event, we will also provide top catering and other services. All conference rooms have natural daylight and are equipped with the cutting-edge audiovisual technology. The big advantage is also a walking distance to the nearby Prague Congress Center and the hotel's location in the historic city center.









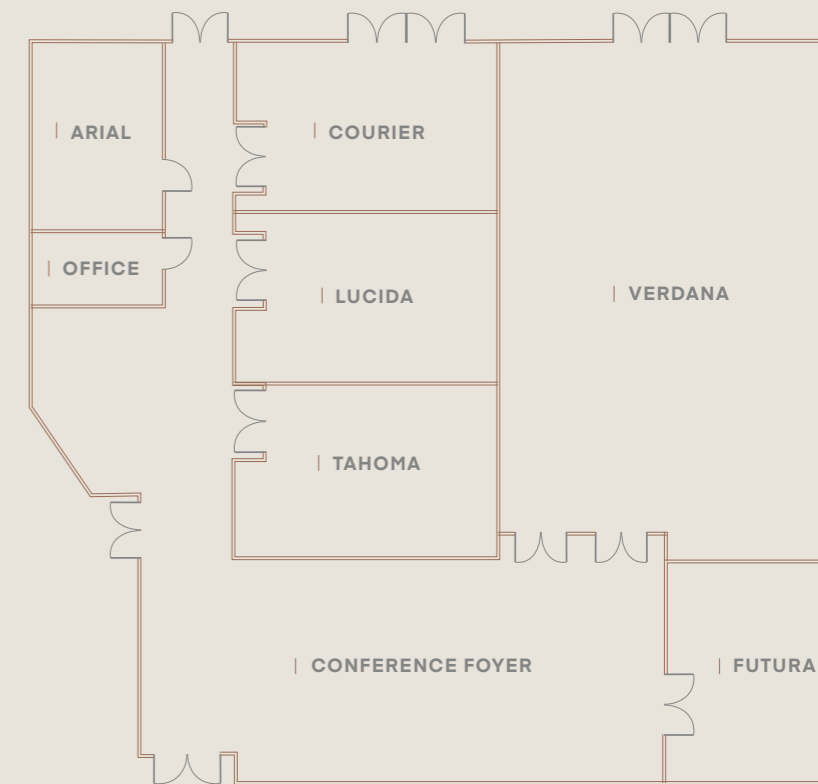









Meeting Rooms

-  6 MEETING ROOMS
-  160 MAXIMUM CAPACITY
-  210 GUEST ROOMS
-  TOP CATERING
-  STATE-OF-THE-ART AV TECHNOLOGY
-  FULL SERVICE



-  Free Wi-Fi
-  Daylight
-  Individual Climate Control
-  High Q. Audiovisual Equipment
-  Ergonomic Chairs
-  Breakout Rooms
-  Parking
-  Outside Smoking Area
-  Digital Navigation System
-  Banqueting Coordinator
-  Hospitality Desk
-  Business Center
-  Foyer
-  No Columns





Your Type of Exercise

On the top floor of the hotel, you can find the fitness center. In addition to modern equipment, it also offers an open terrace and a breathtaking view of the Prague skyline. Thanks to the great location of the hotel, we recommend you to take advantage of popular running trails and cycle tracks along the Vltava River. A quiet park around Vysehrad Castle is a great place for a walk or jogging.



Your Type of Place

The most visited tourist sights and the historic city center are easily accessible on foot or by public transport from the Hermitage Hotel Prague. In the immediate vicinity of the hotel, there is the ancient Vyšehrad Castle offering stunning view of Prague or the lively Vltava riverbank called Naplavka where you can spend pleasant time with children, go biking or jogging in the morning.





Vysehrad Castle

One of the two oldest monuments in Prague with remains of a 10th-century hill fort, rises on a rock just above the Vltava River.



Naplavka Riverbank

A popular place along the Vltava River, full of open-air bars and cafés in the summer, serves as a venue for many cultural events and the Saturday market.



Prague Cubism

A unique set of avantgarde buildings from the beginning of the 20th century, which has made Prague world-famous.



Prague Congress Center

The Congress Center, a place hosting the most important, world-class events, is really at your fingertips from the Hermitage Hotel Prague.



Botanical Garden

The exquisite Botanical Garden of the Faculty of Science of Charles University has been opened since 1898.



Sport activities

In the vicinity of the Hermitage Hotel Prague, there are plenty of opportunities to stretch your legs and get moving.





Transportation



Vaclav Havel Airport Prague
18 km/30 min. by taxi



Main Train Station
1 500 m/15 min. by public transport



Metro st. **Karlovo nam.** — Metro **B Yellow line**
 exit Palackeho nam., 700 m/7 min. from the hotel



Tram station **Albertov** — Tram No. **7 14 18 24**
 150 m/3 min. from the hotel



Tram station **Vyton** — Tram No. **2 3 7 17 21**
 200 m/4 min. from the hotel





Contact Us

HERMITAGE HOTEL PRAGUE

Svobodova 1 | 128 00
Prague 2 | Czech Republic

- T.** +420 225 995 225
- F.** +420 225 995 111
- E.** info@hermitageprague.com

RESERVATIONS

- T.** +420 225 995 533
- F.** +420 225 995 111
- E.** reservations@hermitageprague.com

FRONT OFFICE

- T.** +420 225 995 225
- F.** +420 225 995 111
- E.** frontoffice@hermitageprague.com

SALES

- T.** +420 225 995 601
- F.** +420 225 995 111
- E.** sales@hermitageprague.com

